

Bartels & Vedder BV

Bartels & Vedder BV is an engineering and consultancy agency, specialising in engineering infrastructures, land based buildings, floating structures and flood proof building.

The company is founded in 2011 after its owners developed numerous new building techniques and floating foundations since 2004 in a development and engineering firm.

Together with a team of specialist, who use an integrated and interdisciplinary approach and in addition to traditional construction, infrastructure, and non-residential construction also serves the area of off-shore and floating. At Bartels & Vedder, we pride ourselves on working as a team with specialists, from feasibility studies to actual realisation of the project, working on innovations and making buildings possible. This all from a practical sense and coming with realistic solutions.

We have done the feasibility study, engineering, supplied the floating techniques, and did the project and site management for one of the larger floating commercial buildings in the world, the floating ferry terminal in Malaysia of 6,000m².

We also engineered the largest floating



office in the world, The Floating Office Rotterdam (FOR), in which we designed the floating foundations and were the lead engineer of the project.

For more information, please visit:

T +31 6 422 398 53
info@bartelsvedder.nl
www.bartelsvedder.nl



Ingenious Lighting
 Turn to page

4-5



Southside Waterjet
 Turn to page

6-7



TDCA
 Turn to page

15



Service Sealing Solutions Ltd
 Turn to page

18



DCON
 Turn to page

24

Quality bespoke joinery – crafted to perfection



Bluerun manufactures quality, bespoke joinery items and everything is made to order, nothing is 'off the shelf.'

If you're looking for items made from both hard and softwood or even veneered and painted panels, Bluerun can reproduce an array of items including replacement sashes, where it can manufacture a brand new one on a like for like basis, so the mouldings will match.

Bluerun only produce purpose made joinery to client's drawings and specifications. Its unrivalled level of customer services means that free quotations are normally provided within 2-3 days or less, and the company can usually deliver a quick turnaround of any manufactured items required. And, because it has an



experienced spray operative in charge of a modern spray paint and lacquer facility, articles can leave the factory in a fully finished state, ready for installation on-site.

What really sets Bluerun apart is that since its establishment it has never used computer aided machinery for any designs. Crafted to perfection, all items are finished by hand, drawings are prepared with pencil and paper, and everything that is manufactured by the team has been done so with the utmost attention to detail.

T 01799 599995
dee@bluerunltd.co.uk
www.bluerunltd.co.uk

CONTENTS



8-9



16



19

- Commitment To Excellence 4-5
- Commitment To Excellence Award 6-7
- Building Products & Services 10
- Outdoor Building Landscaping & Outdoor Building 11
- Building Products & Services 12-15
- Building Products & Services 16-18
- Waste Water 19
- Building Products & Services 20-21
- Concrete Washout Solutions 23
- Health & Safety 24



Building & Construction Review

Hello & welcome to Issue 399 of BCR...

In this issue of Building & Construction Review, we bring you the latest and most up-to-date engineering and construction news, to help keep your building business ahead of the curve.

From the circular economy, to cutting-edge technology, we look at how businesses across the construction industry are meeting the UK Government's 2050 sustainability targets, with ingenious, inspirational ideas.

Southside Waterjet has been selected for their Commitment to Excellence, as a market-leading CNC stone fabrication company in the London area. Using the latest CAD technology, this company offers exceptional commercial tile, stone and porcelain fabrication from its new facility in Bepton, East London. Investing in five axis CNC Bridge Saws and four metre waterjet cutters has put the company ahead of the curve. Understanding the importance of environmental issues, the London heavyweight has secured a purpose-built water recycling plant on-site, to carry out water recycling. [Read more on page 6-7.](#)

Dutch pioneer Bartels & Vedder BV is an engineering and consultancy agency with a difference- they specialise in floating water structures, such as the world's largest floating office in Rotterdam (FOR.) Working around the world on engineering projects, the company has a steadfast commitment to renewable energy in these amazing engineering feats. [Seeing is believing, read more on page 1.](#)

We all know how lighting can change the mood and aesthetics of a whole building or even a single room. [Meet Ingenious Lighting on page 4-5:](#) the bold, daring, creative specialists in the design and manufacturing of some of the world's most beautiful lighting products and systems. Read about the bar and reception lighting design for the five-star Radisson Bucharest Hotel and you will see why they are worthy recipients of our Commitment to Excellence. This company also understand the sustainability brief and designed V2 engines, with greater energy efficiency for international hotel settings. This is a fascinating read.

Other topics explored in this issue include bespoke joinery, best practice in timber cladding and decking, eco-friendly plywood substitutes (OSB), railway sump cleaning, duct sealing systems for utility services and watertight seals and ISO 9001 quality & ISO 14001 environmental management audits.

Don't forget to send us your latest construction updates and news.

Email us at: buildings@bestpracticeuk.co.uk



Liz Dickinson
BCR
Editor

Contacts

Publication Management

Sam Morton
Sales Manager
T 07894 909036
buildings@bestpracticeuk.co.uk

Production

Robert Sharp
production@
businessandindustrytoday.co.uk

Accounts

Paul Whitaker
Accounts Manager
T 07974 087740
accounts@bestpracticeuk.co.uk

Editorial

Liz Dickinson
Editor
liz@freshmedia-uk.co.uk

Air conditioning and heating solutions



Clima-Tech was founded in 2015 by Ashley Shemmings, a self-employed specialist in heating engineering with over 18 years' experience in the engineering industry. Clima-Tech is a family run business and alongside Ashley, wife Franki Shemmings works in the office. What started off as a maintenance and servicing company, soon evolved into a specialist multi-faceted service with a proven track record in the electrical, refrigeration, domestic, and commercial sectors.

Clima-Tech is well trusted and well established in the renewable energy field. Clima-Tech is hands on and works closely with its clients to ensure that the best service is delivered. Clima-Tech is an approved contractor by the following certified bodies: Microgeneration Certification Scheme (MCS), Renewable Energy Consumer Code (RECC), IWA, and REFCOM. Furthermore, Ashley has trained to the highest level, holding qualifications such as City and guilds 2360 NICEIC certified, City and guilds F-GAS, B-PEC G3 unvented, B-PEC Heat pump design, and B-PEC water regulation.

Clima-Tech has been the receiver of many awards over the years receiving first, second and third place in the following: 2019 National Energy Efficiency Awards, Energy Efficiency Champion and

Commend Renewable Heat Installer & Contractor 2020/21 and the National Energy Efficiency Awards 2020/21. Another milestone for the company was in 2021 when Clima-Tech employed its first member of staff.

Clima-Tech specialise in a range of core services in the renewable energy field for MCS/RHI registration systems, Heat pumps, Heating systems, Electrical system design and installation, System commissioning, Air conditioning, Solar panel specification, design, installation, repair and maintenance, and Underfloor Heating and Plumbing works.

We now have a showroom open in Martlesham. We want to help more households experience the benefits that heat pumps can bring - and to encourage early adopters to make the move. Our showroom will share information about all the advantages of heat pumps, while busting myths about barriers to adoption. Our showroom has a working heat pump in place to demonstrate the technology in action, alongside everything that goes with them, including cylinders and controls.

Contact

T 01473 798321
ashley@clima-techservices.co.uk
www.clima-techservices.co.uk

New small duct heating and cooling system set to tackle rising temperatures in UK homes

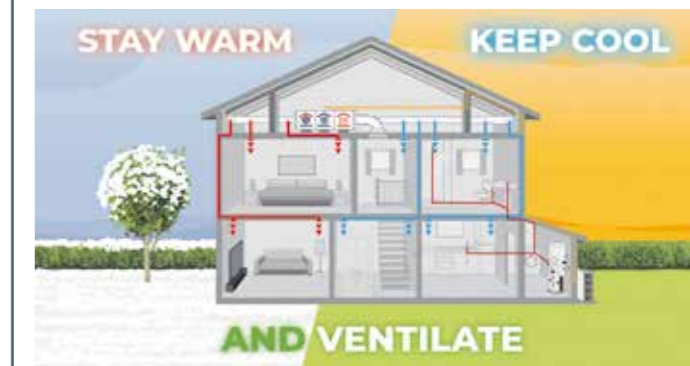

A new small duct heating, cooling and ventilation system by US manufacturer Unico Systems has been launched in the UK.

The Unico System, which is installed in half a million homes and businesses throughout the US, provides heating, cooling and ventilation along with improved air quality and well-being.

The decision to make the Unico System more widely available to UK residents follows a series of record-breaking summers, as well as increasing demand for greater climate control.

The near silent, system, which operates at under 30 decibels, uses aspiration to deliver draft free heating and cooling ensuring temperature

differentials are no greater than one degree throughout the home.

Richard Soper CBE, of Unico Systems UK, said, "The US is used to much larger variances in temperature, meaning that domestic ventilation and air conditioning is often installed as standard. As a result, the Unico system is fully adapted to the needs of domestic properties; providing effective climate control, but also operating at a barely audible sub-30 decibels. For self-builders and renovators this provides a unique opportunity to give occupiers the same level of climate control and comfort that they've come to expect in cars, hotels and gyms, no matter the season."

T 01384 422094
unico@bellplumbing.co.uk
www.unicosystem.co.uk



Luminaires lighting the world



In this issue of Building & Construction Review, we are honoured to select Ingenious Lighting with our Commitment to Excellence.

Ingenious Lighting is a market-leading specialist in the design and manufacture of aesthetically beautiful but including cutting edge technology to create world-leading standard and bespoke-lighting products and systems. Working with only the best expert craftspeople for over 35 years, the company has produced customised luminaires for the following:

- ▲ Blue-chip interior projects
- ▲ Exterior & marine applications
- ▲ Architectural metalworks
- ▲ Turkish & Iznik tiles and ceramic production
- ▲ Decorative glass works
- ▲ Large-scale monolithic marble works (staircases, columns, fountains etc)
- ▲ Traditional woodworks such as: kundekari & marquetry techniques
- ▲ Silversmithing including: hand sawn piercing, chasing, shaping, soldering.
- ▲ Monolithic acrylic production and fabrications in both the USA & Thailand

One such case-study is the ice bar and reception lighting for the five-star Radisson Bucharest Hotel. Ingenious Lighting's Founder and Design Director, Simon Rozenberg designed the stunning ICE BAR with both white & blue lighting, giving the impression of floating, mystical lanterns from



eye-level to ceiling height. With in-ground blue LED wall washers at the base of the columns, the lighting gives off elegant hues of indigo, violet and pale, majestic mauve. The overall effect is chic-futuristic: relaxing and yet, beautifully idiosyncratic.

With an accomplished background in Product Design, CAD and Solid-State Lighting, Simon brings innovative flair to the global lighting design & manufacturing industry and is always looking to push aesthetic lighting boundaries, alongside a team of partners.

Ingenious Lighting has a triple-hat trick in new product development, with its ingenious new LED skylights, V2 engines and Deck-60 for marine applications. The LED skylights come in two varieties: Type "D" and "T" for a versatile addition.

Many international hotels around the world have struggled with the energy efficiency of ES/BC based LED lamps in hotel conference rooms and bedrooms. The costs of replacement lamps and labour was excessive and more pertinently in the age of sustainability, the lamps were not recyclable. Ingenious Lighting is wholly committed to the circular economy and designed the V2 engine, for usage in both 240VAC and LV-DC. With "TRIAC" dimming control and 12V constant current versions, the V2 can power for a phenomenal 50,000 hours, allowing hotels to focus on customer service expertise with patrons.

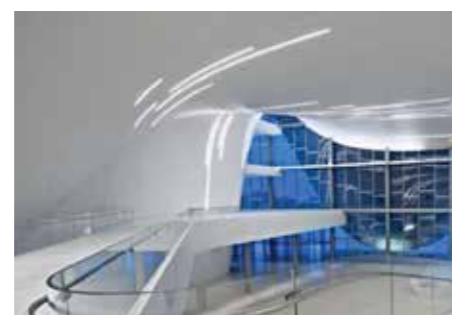

Specially manufactured Creart Brass & Gilded roof section, Heli - lifted into position!

The V2- IP66 design is currently being perfected for an ambitious project in the Kingdom of Saudi Arabia.

Thirdly, the DECK-60 by Ingenious Lighting is an impressive bespoke project-orientated product, designed and manufactured in-house for marine usage. Using a robust 316 Stainless steel and bronze construction, the 300lm LED is sealed in a waterproof bulkheads/backbox and again, provide 50,000 lighting hours.

We spoke with luminaire extraordinaire, Founder and Design Director, Simon Rozenberg to find out what makes this company so unique,

"We work as a co-operative, collaboratively with lighting designers, architects & M&E contractors, considering all aspects of the technical, aesthetic and budgetary brief. This harmonious way of working allows us to streamline our talents together and puts us way ahead of our competitors.

Our partners include: RZB, CoeLux, CNC lighting, RK Lite, PUK & Diamante- this gives us an eclectic, diverse product resource to call upon at all times. Ingenious Lighting manages and collates all the product information, expertly designing and engineering all the bespoke products as required.

We are proud to say that we have spent the last 35 years developing and manufacturing products for the best lighting designers, architects and their respective global blue-chip projects."

The pedigree and calibre of these quality collaborations brings exceptional design to the foreground: CoeLux allows customers to experience the sky with their original creation of the Virtual LED skylight 60HC installation. CoeLux are masters of scenography, optimising natural light and space through high-end LED sources and nano-structure panelling.

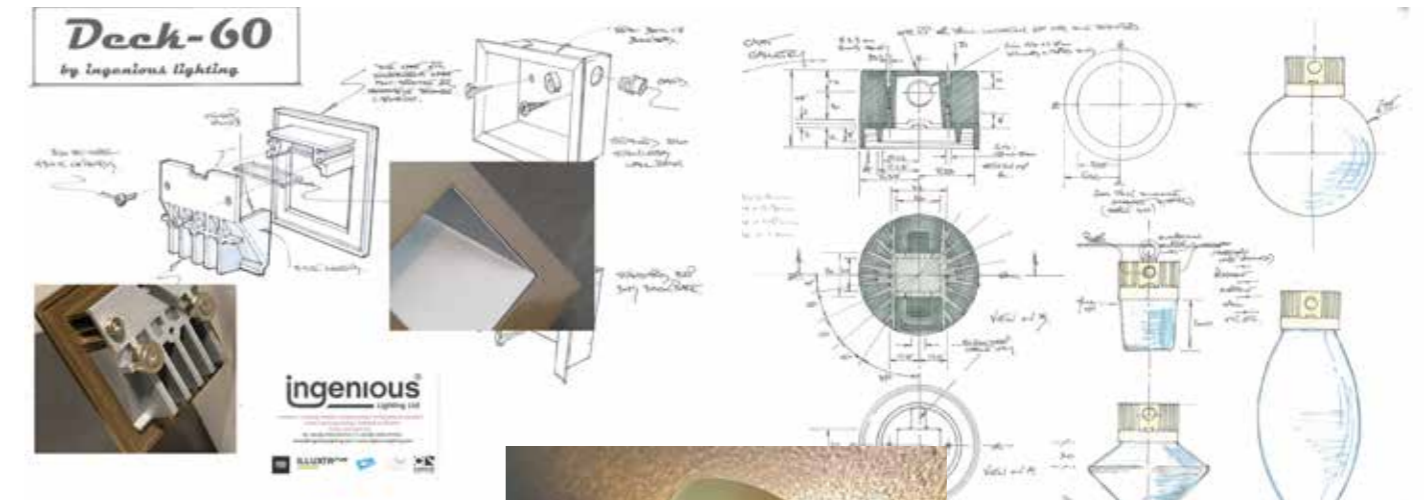

Award-winning RZB Lighting have been lighting manufacturers for over 80 years, they manufacture an extensive range of architectural, commercial and industrial products and have been the recipients of numerous industrial prizes including 'iF' Design Awards and Light & Building Awards. The latest exclusive range of pendants employ cutting-edge 6mm clear acrylic <UGR19 direct/indirect light guide, precision- designed for meeting rooms and offices.

Diamante Lighting are masters at versatile lighting designs for extreme climatic conditions, from freezing Baltic winters to the Arabian Peninsula. With expert knowledge on all aspects, from installation to bespoke adaptations, they can offer a full portfolio of outdoor lighting products, with variations in beam angle, light flux and dimensions,



New V2-IP66 In development for Saudi Arabia project

in 1961, when they set up their own factory in the financial centre: Mumbai (then called Bombay), on the West Coast. Through stringent quality control and with their own in-house design studio, these products became widely acclaimed for their unparalleled design aesthetics and their fail-safe durability.

In 1971, the Company started exporting its products, from then onwards, growth at the Rajkamal Trading Corporation took place at an even faster rate. Today, these products have pride of place at leading institutions and establishments all over Europe, Asia and the Middle East. They have a portfolio of valued and prized clients including: The Taj Group of Hotels, The Oberoi Group of Hotels, The Leela Kempinsky Group of Hotels, The Centaur Group of Hotels, Sheraton Hotels and almost all the leading Hospitality organisations across the globe."

Ingenious Lighting offers a truly bespoke-service to customers around the world including: initial research and design concept, patent searching, prototyping, CAD- design, to meticulous testing, expert manufacturing, packaging and dispatching. On more than one occasion, 'thinking outside the box' is required, such as using a helicopter to lift, transport and position a specially-manufactured Creart Brass & Gilded roof section!

We asked Simon what the rest of 2023 had in store for Ingenious Lighting,

"We are excited to reveal our plans for the opening of the Ingenious Dubai office, in the United Arab Emirates (UAE), in conjunction with RKLITE & CNC Lighting.

RKLITE & CNC Lighting were established in India

For all initial consultation and quotations, contact Simon Rozenberg to discuss all projects:

T +44 (0) 7785 953715
T +44 (0) 1908-377329
simon@ingeniouslighting.com
sales@ingeniouslighting.com
www.ingeniouslighting.com



Unveiling of new facility for top London stone fabrication company



Peter is the heart and soul of the company, bringing both passionate know-how and professional customer service to the foreground. The company prides itself on approachability, with Peter often acting as chief salesman and working with customers throughout the whole project process. We asked Peter more about recent company changes and the benefits of waterjet cutting.

"We have just opened our new state-of-the-art, upgraded facility in Beckton, East London. This premises is three times the size of the previous River Thames site, with £500,000 worth of new investment. We are delighted with our 5 Axis CNC Bridge Saw and 4 metre waterjet cutters, for improved high-volume capability. The facility is conveniently near the A13 trunk road, for all existing and new customers. Our opening day was perfect- we invited all our loyal customers from architects to building contractors and can't wait to expand our business further.

Our business is sustained through exceptional word-of-mouth- our customers are expertly looked after, from initial consultation to project completion.

Using twin head waterjet machines, we are able to keep up with high-demand across the commercial construction industry and meet our sustainability targets. The purpose-built water recycling plant at Southside Waterjet's new

industry-standards, winning repeat custom from contractors. Each member of the team is expertly trained in CAD-3D rendered and technical drawings, allowing a seamless vision of each stage of the project. Furthermore, digital templating provides a state-of-the-art templating solution- especially for measuring and fabricating stair coverings and final templates of kitchen worktops and splashbacks.

All measurements can be expertly reviewed, altered and finally exported as ready-to-see production files for CNC waterjet machines, providing quality assurance throughout. Cutting-edge Digital Slab Creation also lets the team magically transform an image of a slab into a wholly realistic representation. This is ideal for when using the slab for a vein or book matching, for waterfall worktops or feature wall covering.

What stands Southside Waterjet apart from its competitors, is the usage of cutting-edge waterjet technology and its exceptional customer service.

In this issue of Building & Construction Review, we are delighted to award Southside Waterjet with our Commitment to Excellence Award.

Southside Waterjet is a market-leading CNC Stone Fabrication company, utilising cutting-edge material CAD technology. Working with the biggest names in construction across London, Southside Waterjet provide expert commercial tile, stone and porcelain fabrication.

Working across bespoke residential and mainly large-scale commercial projects, this expert commercial fabricator can provide everything from kitchen islands, customised flooring, wall coverings, quality worktops and splashbacks, bathrooms, wet rooms to outdoor furniture, swimming pool solutions, to signage, fit-outs to the retail, leisure and hospitality sectors.

Established in 2012 by Managing Director: Peter Noyce, Southside Waterjet prides itself on precision-fabrication techniques to the highest



facility allows for purposeful water recycling and alongside our recycling programme, we are delighted to be contributing to the UK's circular economy."

Waterjet cutting uses a highly-pressurised jet stream of water to cut a variety of materials, similar to how acute erosion would work in nature, changing cliff formations or rock formations. However, waterjet cutting works at higher-volume in a repeated, accurate fashion across materials such as tile, stone and porcelain, in this case.

There are many documented advantages to using waterjet cutting, over alternatives such as laser cutting, such as:

- ▲ Greener technology- no hazardous waste is produced; no cooling oils or lubricants are needed; it enables the recyclability of scrap metal and uses minimal water levels.
- ▲ Precision- accuracy: capability of 0.01 mm accuracy, with detailed cuts/3D shapes.
- ▲ Thickness cutting of 12" of most materials
- ▲ Ability to cut through a wide range of materials from stone, ceramics, metal, glass, wood and rubber (laser machines cannot cut through stone or marble)
- ▲ Cold-cutting process: waterjet cutters won't overheat areas next to the cutting space, allowing those sections to remain unaffected.
- ▲ No switching cutting tools for new product= easy operationality
- ▲ Versatile cutting- curves, straight edges, lettering to holes, with precision-accuracy and speed.
- ▲ Vastly superior, smooth edge quality- negating need for secondary finishing
- ▲ Cost-effective- low energy, less material disposal = surprisingly lower quotes

Southside Waterjet uses unparalleled Waterjet Sweden NC 30 machines, with two HP pumps, for unbeatable service and now with its new enlarged facility, can offer a quicker turnaround on commercial projects.

Furthermore, the company's fabrication service allows the highly skilled team to flawlessly transform any original idea into a unique project. Using next-generational CAD technology,

precision CNC waterjet cutting enables the craft of raw materials into high-quality design solutions, with unparalleled precision and endless creative possibilities. To further enable this, edge profiling adds meticulous, beautiful visual details to any project.

Southside Waterjet can design three edge profiles:

- ▲ Mitred
- ▲ Bevelled
- ▲ Semi Bull Nose

Some illustrations of how edge profiling can be applied include:

▲ **KITCHENS:** from contemporary to traditional kitchen styles, the edging profile of worktops can harmoniously complement the finished outcome.

▲ **SWIMMING POOLS:** Anti-slip grooves and finger grips can be cut into tiles surrounding swimming pools, with pool side grating fabricated from the same material to seamlessly carry away standing water from the pool's edge.

▲ **STEP TREADS AND STAIRCASES:** In high traffic areas of commercial and retail environments,

anti-slip features can be added to stair treads or for a higher end look finished with metal inserts in a metal of your choice.

Surface profiling proves useful when it comes to abrasive blasting, as it is used to smooth a rough surface or roughen a smooth surface. Abrasive blasting is commonly used by the expert in-house team to create decorative embossing effects and as a lasting-branding solution.

Or for an alternative finish, with stone now being the most popular choice for worktops and flooring, Stone Polishing can be applied, and due to its inherent durability and longevity, the polished finish is high-end and often referred to as the 'height of luxury.'

The website includes recent case studies such as the All-England Lawn Tennis Club and Field Cottage, complete with a stunning portfolio of visual imagery, to give prospective companies an idea of the high-end refurbishment quality.

To talk to Managing Director: Peter Noyce or to enquire further, see the details below:

T 02032 212133
www.southsidewaterjet.com



Building success: CARLISLE® Construction Materials grows ARBO® team to provide unparalleled service and expertise



L to R: David Black and Shail Chauhan with the award.

In this issue of Building & Construction Review, we are delighted to select Carlisle Construction Materials (CCM) as winners of our Building Products & Services Innovation Award.

CCM has expanded its team of experienced professionals to provide comprehensive ARBO® Sealants systems expertise to meet the evolving needs of the UK construction market while delivering unparalleled value and service.

CCM's investment in this enhanced team brings together an exceptional blend of expertise in sales, marketing, technical support, customer service and product management, equipping the company to provide a full service that caters to the requirements of architects, specifiers, contractors, sub-contractors, sealant applicators and specialist distribution partners.

Leading the UK Sales and Marketing team is

Dave Black, director of UK sales and global export for ARBO, who brings extensive industry experience in building, distribution, and manufacturing to CCM. His relationship-building skills and focus on meeting customer needs, have led to strong partnerships with senior representatives of market-leading organisations.

Mark Halliday, is CCM's new divisional facade and technical manager for the UK, joining the ARBO façade team with over 25 years' experience in the construction industry. With his extensive knowledge of the specialist building façade sector Mark is a trusted professional, advising customers with solutions for complex contemporary building designs. Mark has recently taken full control of the UK-based technical team, which will also support our specification façade strategy for ARBO.

Also new to the ARBO team is David Henning, CCM's area sales manager for ARBO in the Southeast, who brings more than 20 years of

specification and technical sales experience to the table. David has established strong relationships with customers at various levels, and his expertise spans distributors, manufacturers, contractors, architects, and engineers. He will be instrumental in supporting and advising on CCM's building envelope product portfolio, ensuring a smooth specification and procurement experience for customers.

Neil Roberts, is CCM's new product manager for the ARBO range of building envelope systems, joining the team a wealth of industry knowledge. With a background in multiple building product sectors, including waterproofing, roofing and flooring systems, Neil's technical understanding will guarantee that ARBO products always meet the highest standards and regulations. Neil works closely with European and US-based CCM colleagues to drive the development of the ARBO product portfolio.

Kay Knight joins CCM as the dedicated



ARBO Sealants S range

Marketing Manager for ARBO. Kay is an experienced marketer with a deep understanding of the construction sector, having previously worked closely with



ARBOMERIC MP10 and 20

contractors, building product manufacturers, and distributors. Kay also has the skills to effectively communicate the value of ARBO building envelope, sealing and façade systems to architects, specifiers, applicators, contractors and key distribution partners.

Strengthening CCM's sales team is Tim Jennings, a seasoned ARBO area sales manager in the sealants and building envelope sectors operating within the Midlands, South Wales and Southwest areas. Leading on the technical performance side of CCM's sealant business and assisting customers, Tim has over twenty years' experience within the construction sector and an extensive understanding of the silicone market.

Mark Maslanka, our façade sales manager has over 40 years' industry experience covering a wide range of relevant construction sectors. Mark's remarkable expertise and customer-focused mindset make him the ideal partner for architects and specifiers seeking innovative and efficient façade solutions.

Mark Bunting, CCM's area sales manager for ARBO, has been offering unrivalled expertise to the company's Northwest customers for over nine years. He has an in-depth understanding of CCM's sealant products and systems and provides specialist sealant and building envelope advice for architects, specifiers, sealant applicators, contractors, and specialist distribution partners.

Robert Calladine is CCM's export administrator, based at the company's ARBO head office. Robert's extensive knowledge of the processes, legislation, documentation, and attention to detail needed for exports, delivers a smooth export customer service experience worldwide, and ensures compliance with local market requirements globally.

The up-and-coming future star of the CCM team is Tilly Davies, ARBO sealants area sales manager for the Northeast. She brings over three years' experience in the waterproofing



ARBO FR-RS Fire Tape

sector to the business.

Michelle Jefferies, CCM's head of customer services at ARBO, brings 15 years' experience in the customer service industry to her role. Under Michelle's guidance, CCM has built a strong and committed customer service team, who share her enthusiasm for providing excellent customer service across the company's comprehensive range of ARBO sealant solutions.

Dave Black, Director of UK sales & global export ARBO, comments: "Our service to customers is driven by our innovative products and the quality of our people. Our recent intensive recruitment campaign reflects a significant commitment to providing the highest standards of knowledge and technical support to our customers and builds on the experience already within our business.

"Our goal is to support our full customer portfolio - both current and new - with integrated high performing building envelope and sealing solutions, from product selection and specification, through to technical support and BBA-certified warranties. We're proud to have built a team that reflects our cradle to grave service commitment, with the proven performance of our diverse product range."

For more information about how the ARBO team can work with you to understand your unique sealant and façade solution requirements please call +44 (0) 1773 826661 or visit arbo.co.uk



L to R: David Henning, Tim Jennings, David Black, Mark Bunting.



L to R: Mark Maslanka, David Black, Mark Halliday.

ESP Panels extends the life of panel products

There has, up until now, not been a product that solves the problem of water penetration to the inner veneers of plywood which when wet cause the glue-line to fail. Following successful testing by BM TRADA we now have that product. Specifiers and architects can now once again have confidence in softwood plywood and panel products. No longer do you need to specify the more expensive hardwood marine grade ply. Simply apply ESP Panels and confidence can now be restored.

ESP Panels extends the life of panel products by creating a watertight seal around the edge of the boards, stopping moisture penetration to protect against delamination.

Ideal for external use and high-humidity areas. ESP is proven to make plywood last longer. The Plywood Sealant is applied to the bare edges (including freshly cut edges) of the plywood boards. A thick layer is painted down the edge with a 5mm overlap onto the flat surface. Ensure that any holes or



air pockets are completely covered. This can be done by working the sealant along the edge, back and forth with a paintbrush.

Available in all good Timber Merchants or contact us today if you too would like to become a stockist.

Contact details:
sales@esp-timbertreatments.com
www.esp-timbertreatments.com



Shou Sugi Ban® Sustainable Cladding

Shou Sugi Ban® is a premium brand of charred timber cladding. It is specified when there can be no compromise on a building's aesthetic, practical and environmental credentials.

Using a traditional Japanese wood preservation technique, we transform sustainably-sourced timbers into charred cladding. This handcrafted process boosts the natural properties of the wood. The result is a weather resistant building material that adds a stunning finish to contemporary builds and heritage renovations.

Manufactured in our Buckinghamshire workshop, Shou Sugi Ban® is shipped to residential, commercial and public projects across the UK.

Our quality timber cladding range includes:

- ▲ Traditional textured blackened wood such as Yūkari Umi
- ▲ Deep brushed timbers with defined grain including Larch Shiberiatora
- ▲ Light coloured and smooth timbers like Kebony Legima

See the full range on our website:
<https://exterior.supplies/charred-timber-cladding>

As an exterior finish, timber cladding enhances the thermal efficiency and sound proofing of a building. The charring process aids preservation, making Shou Sugi Ban® a low maintenance building material, that is also recyclable.

Exterior Solutions Ltd is a specialist in the manufacture and supply of Shou Sugi Ban® charred timber cladding. Please get in touch for further information, quotes and samples.

Contact
 T 01494 711800
<https://exterior.supplies>



Temporary Catering facilities for use during Kitchen refurbishments



Mobile Kitchens Ltd specialises in the hire of temporary catering facilities and foodservice equipment.

Ideal for events or to provide temporary catering facilities during your kitchen refurbishment, our versatile units and equipment offer an efficient and economical solution to the caterers' needs.

Production Kitchens, Preparation Kitchens, Warewashing Units, Dry Store Units, Cold Rooms and Restaurant Units are available as individual units in their own right or they can be linked together on-site to form a complete complex.

Alternatively, we can offer modular, open-plan

facilities, usually for larger, longer-term hires. We offer a free design service, and project management from concept through to delivery and installation on-site, plus full technical support throughout the hire period.

The standard specification of our Medium Production Kitchen unit includes a six-burner oven range, salamander grill, twin basket fryer, undercounter fridge, undercounter freezer, hot cupboard, double bowl sink unit with integral hand wash basin, storage racking, plus ample power points to plug in Microwaves, Food Processors, Toasters etc. Internal equipment can be interchanged, and clients can effectively specify their preferred layout.



We have many tried and tested design layouts and would be pleased to put forward our recommendations for your project.

So, if you're planning a refurbishment or need to cater for an event then why not give us a call and we'll be happy to provide advice and put forward a competitive proposal.

For further information or to arrange a site, please visit, email: sales@mk-hire.co.uk or call us on: 0345 812 0800 or visit our website: www.mk-hire.co.uk

CLIENTS INCLUDE

CALLING ALL ARCHITECTS, LANDLORDS +more

- ✓ **Help your Client even more:** Great Advice built on 40+ yrs experience. ... e. g. Rental Options; £13k pa rental > Could **earn £160k pa** income.
- ✓ ... e. g. Many more 'Onsite Income' ideas (speak with us).
- ✓ **Themed to your Venue/s:** Bespoke Styles & Systems, ANY Space or Shape!
- ✓ **Limitless Design:** Limitless Features, Colours and Styles.
- ✓ **Smarter Systems:** eg. Make the most of your space; especially height!

UK Manufacturer. All-in-House. + Best Value per capita!

GET FREE ADVICE TODAY...
+44 (0)1792 422 818
mike@playcraftgroup.wales

OUTDOOR adventures **TRAMPOLINE SYSTEMS** **SOFT PLAY SYSTEMS**

playcraft GROUP

... Good Health through play

Trustpilot "Excellent"

Peace of mind for your park and leisure home

- **Surveys & Inspections**
- **Annual Service Plans**
- **Interior Finishing (post sitting)**
- **Aftersales works**
- **Refurbishment works**

Tel: 01509 807115
 Email: info@clearviewphs.co.uk
 Web: www.clearviewphs.co.uk

learn ecology

PROVIDING ECOLOGICAL EDUCATION AND CONSULTANCY SERVICES ACROSS THE UK

Comprehensive, pragmatic ecological solutions to planning constraints benefitting from years of experience. Providing a range of services such as Ecological Appraisal, Biodiversity Net Gain, protected species surveys including bats, badgers, and great crested newt. Learn Ecology delivers a personal approach to each and every client, with dedicated project managers to see your site through from start to finish. Learn Ecology Ltd – ecological services, for everyone.

Visit www.learn-ecology.com
 T: 07841 629273 | E: info@learn-ecology.com

Looking for quality landscape & building materials from a trusted supplier?

Established in 1998, Stone Zone and Landscaping Centre are a nationwide trade supplier, offering quality landscaping and building materials at trade prices.

Greenkeeper? Their Wessex range consists of Bunker Sand, Silica Sand, Dutch Tree Sand and more. They can even make bespoke soil blends tailored to your requirements!

Recently being awarded with the Gold Trusted Service Award for 2022, this family-run business offers a 10% discount to Trade card holders and fast delivery.

To cater to the environmentally conscious, the Stone Zone have developed their own eco-friendly 'Sustainable range', including FSC Certified Oak Sleepers, Composite Decking and locally blended soils.

The Stone Zone has supplied materials to National Trust Parks, Caravan Parks, Housing Developments, Golf Courses, The Tower of London and many more affluent settings!

Stone Zone pride themselves on being 'a service you can rely on' and are committed to putting their clients at the heart of what they do. With a dedicated account manager, best rates and exceptional customer service are guaranteed.

Now proudly supplying a 'Developers' range, the Stone Zone offer stunning porcelain paving products designed for newly-built homes, at affordable prices.

To find out more, call on: **01202 874207** or email: sales@stone-zone.uk.

Are you a Greensman or



Natural stone proves popular

Cotswold Hill Stone & Masonry Limited was first set up back in 2007 and celebrates its 16th anniversary this year. Cotswold Hill Stone & Masonry operates two separate quarrying sites, Cotswold Hill Quarry, near Ford, on the outskirts of Cheltenham and their Birch Hill Quarry, located at Parkend, near Coleford in the Forest of Dean.

for landscaping sector with the cropped building and walling stone favoured by architects and planners. Sometimes the stone can have a green hue, or even a shock of red within it which provides a more dynamic and contrasting appearance.

From these quarries, they produce Cotswold limestone, Forest Pennant sandstone and also stock Bath, Iron and Lias stone. Cotswold Hill Stone and Masonry provide a tailor made and a comprehensive service, supplying building, landscaping stone, revetment, and aggregates as well as masonry stone.

With such a wide range of services and wealth of knowledge, it's easy to see why so many private and commercial clients across a multitude of industries seek out their stellar services.

The Pennant sandstone from the Birch Hill Quarry is an alluring blue and grey colour that is becoming increasingly popular among those seeking a more modern aesthetic. One of its most frequent uses is

for landscaping sector with the cropped building and walling stone favoured by architects and planners. Sometimes the stone can have a green hue, or even a shock of red within it which provides a more dynamic and contrasting appearance.

Contact
T 01386 584384
www.stonequarries.co.uk

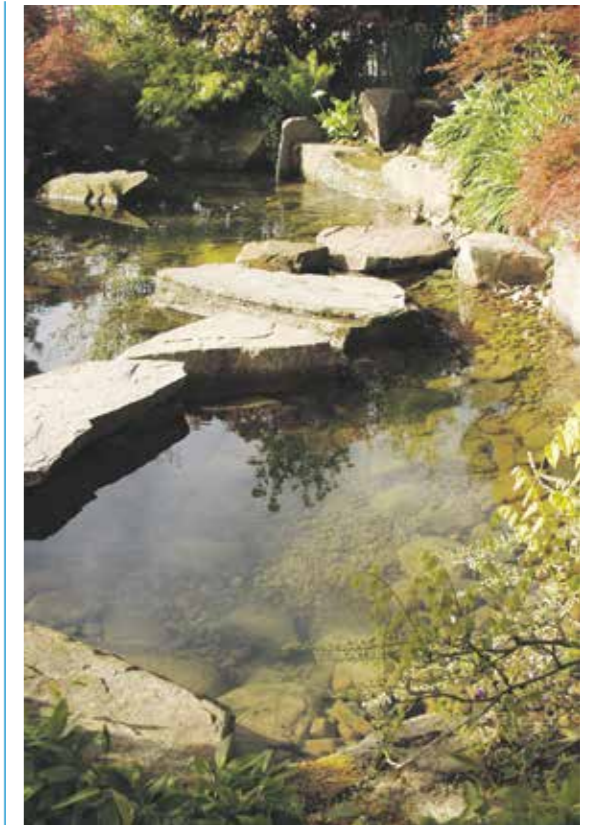

BARNES associates

SURVEY MANAGE IMPROVE

T 01423 322 371
E info@barnesassociates.co.uk
W barnesassociates.co.uk

07483 116044

- TREE SURVEYS FOR DEVELOPMENTS (BS5837)
- ADVANCED TREE ASSESSMENTS
- BS5837 TREE SURVEYS

- Specialists in tree safety risk and stability
- We specialise in safe development techniques near trees.
- Root Detection & Mapping.

The Planter Specialist

From window boxes to tree planters, choose from wide range of stocked designs or custom-made to suit your space.

www.iotagarden.com

The TP Group: The UK's leading multi-disciplinary contractors



The TPG ethos combines a common-sense approach with a 'can-do' attitude. We fully understand our clients' needs and service them in a way that fills them with confidence, often inspiring them to request other services from us.

We will always go the extra mile and, most importantly, get the job done to your complete satisfaction – no exceptions. This is our promise to you: Service Without Compromise.

Contact
T 01277 841415
info@thetpgroup.co.uk
www.thetpgroup.co.uk

Established in 1986, The TP Group has quickly grown to become one of the UK's leading multi-disciplinary contractors.

Based in Essex and operating across London, the Southeast and the Home Counties, our mission is to provide the highest quality of service possible to our clients, with a consultative approach and our 'can do' attitude.

With over 30 years' experience, our specialist teams will provide you with all the expertise your project needs and, above all, get the job done.

Over the decades, we have expanded our range of specialisms and set up dedicated divisions to reflect

our expertise.

Whether you're looking for Painting Solutions, Passive Fire Protection, Surfacing & Coatings, Landscaping, or an integrated mix of services, our professional teams are always on hand to work with you on your projects.

Why choose us?

Our clients know we're not salespeople. We are experienced workers who have all started in junior positions and worked our way up, from the labourers to the Managing Director. We know the length of time things take, the problems we need to overcome, what's achievable and what's not. And we'll always be honest with you.



Timber cladders should heed ventilation warning

Standfirst: A recent flurry of cladding inspection requests received by the Timber Decking and Cladding Association has revealed that basic, fundamental installation principles for timber cladding are being ignored.

Timber cladding is installed as a rainscreen on buildings across the UK. This means the cladding should be fitted over a drained and ventilated cavity, to allow airflow and moisture to escape and give it the longest possible service life.

Ventilation provision is allowed for at the top and bottom of the cladding, while the batten layer or layers – one or two depending on the orientation of the cladding – creates a continuous drainage plane over a waterproof breather membrane.

Unfortunately, several cases where this guidance has not been observed have recently been brought to the Timber Decking and Cladding Association's (TDCA) attention, and it seems TDCA is not alone.

In a recent newsletter, NHBC reported that it 'has

recent experience with the design life of timber cladding being less than intended, leading to loss of performance and claims.' It cites 'lack of detailing to enable drainage and ventilation' as one of the key problems, as well as the use of 'unsuitable film-forming coatings that can trap moisture' and fixings issues. These are all very important factors that builders and tradespeople must get right to prevent future problems.

"Fixings issues have long since been a bug bear of the TDCA in respect to both timber cladding and decking," explains Janet Sycamore, Director of TDCA.

"Most of the cases, we see feature problems caused by using the wrong type of fixing, fixings made of the wrong material, or their incorrect placement and poor application. If you get it wrong the result could be at best permanent, dark, unsightly rust stains or, at worst, boards becoming detached from the wall and potentially causing harm."

The good news is that these problems are easily avoided by following good practice guidance available from the TDCA and Timber Development UK.

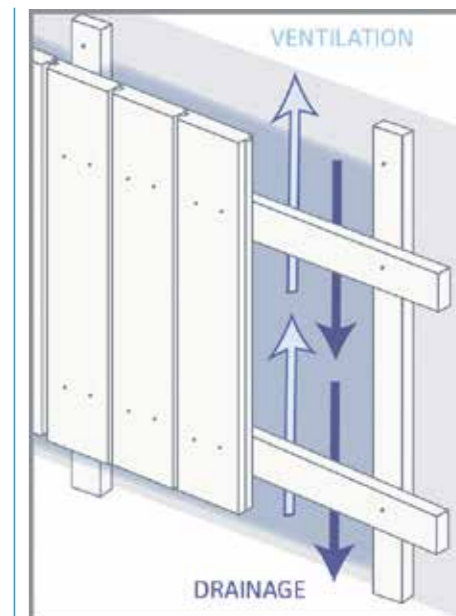

You can find details of this guidance in **The Timber Cladding Handbook**, which is freely available online at: www.tdca.org.uk

For more detailed information, you can also refer to **BS 8605 External Timber Cladding Part 1 – Method of specifying**, which is designed to help manufacturers and specifiers.

M B WILKES
 Sands, Soils, Gravels & Decorative Stone

Your number one choice for aggregates in Bournemouth, Poole and Dorset



MB Wilkes are a family owned sand and gravel quarry, and the leading suppliers of aggregates and building materials throughout Dorset. Our team of aggregate specialists offer a wealth of knowledge in a range of areas; from decorative gravel to garden stones and chippings, our experts have the skills to meet your needs.

Sand & Gravel

Skip Bags

Aggregates

Grab Away

For more information, please visit: www.mbwilkes.com
 Telephone: **01258 857465** | Email: info@mbwilkes.com

Sustainable Solutions: It's time to make the switch

As the world continues to grapple with the effects of climate change, it's essential that we take firm steps to reduce our carbon footprint. One of the most impactful changes that can be made in both the building and landscaping industries is to switch to eco-friendly, low-carbon, maintenance-free solutions.

Eco-friendly products that last a lifetime

Recycled plastic materials offer a number of advantages over traditional wood and metal solutions. Recycled plastic is far more durable than wood, and will never rot or corrode over time. It's also easier and faster to install, often coming pre-cut to size and ready to assemble. In terms of eco-friendliness, recycled plastic is an excellent choice for both building and landscaping. It's completely recyclable, meaning that it can be

recycled and reused many times.

Kedel: A commitment to sustainable living

Leading the charge for more sustainable recycled plastic products is Kedel, a family-run business based in Burnley. With a mission to display the very best in recycled plastic materials, Kedel puts eco-friendly living at the heart of its business, recently working with the National Trust. From recycled plastic decking boards, fencing and cladding to outdoor furniture and building materials, their low-maintenance, affordable alternatives are designed to promote greener living.

For more information, see below.

T 01282 861325
info@kedel.co.uk
www.kedel.co.uk



Understanding SterlingOSB Zero

All West Fraser's Oriented Strand Board (OSB) products are manufactured using selected fibres of timber that are laid in cross directional layers and mechanically pressed to form a structurally-engineered panel, designed for construction and other industrial applications. OSB is viewed by many as the natural successor to plywood because it is more eco-friendly, is home produced and far more affordable, while it contains none of the voids or knots which have historically weakened plywood.

As the boards are essentially formed from individual strands of softwood, some may question their strength and durability, especially if exposed to inclement weather, but this is a misunderstanding of OSB's characteristics.

West Fraser's SterlingOSB Zero OSB3, for example, is BBA-certified, as well as approved for load bearing in humid conditions – being manufactured to EN300 and EN 13986. However, if being used outdoors for extended periods, it can be painted or varnished, plus it can also be treated to protect against fungal and insect attack.

Technological advances mean there is no need to sand OSB boards anymore, as West Fraser is now able to produce them to industry leading tolerances. The latest



boards offer an exceptionally smooth surface, making it an ideal substrate which is easy to work with.

If a floating floor is specified, the installer should ensure that battens for the substructure are appropriately spaced at 400mm centres beneath 15mm boards and up to 600mm for the 18mm version. SterlingOSB Zero boards come in both square edged and tongue and groove (T&G) format, which can be used for roofing and timber frame construction, as well as flooring – making the whole SterlingOSB Zero range infinitely flexible in use.

Check out the West Fraser housebuilders' page <https://uk.westfraser.com/housebuilders/> for useful downloads and product information.

For further information, call 01786 812 921 or visit www.uk.westfraser.com

FireDNA digitally monitors Fire Doors and Passive Fire Products

With the new Fire Safety Regulations having been in force for several months, Contractors, Fire Door Inspectors and Building Owners see the real benefit in using FireDNA

Post Grenfell, we saw an opportunity to introduce a new and innovative way of Monitoring Passive Fire Products in the built environment using the latest digital technologies.

FireDNA is an 'award winning' cloud-based Software and a Mobile App that has been developed for everyone involved in Passive Fire Product Manufacture, Installation, Inspection, Management and Maintenance. As well as for those that live and work within environments where Passive Fire Products are installed and are now required, under new legislation, to be digitally logged and monitored.

FireDNA delivers that digital 'golden thread' for all Passive Fire Products in the built environment from Fire Doors, Panels and Partitioning (including all intumescent seals, glazing and ironmongery), through to Fire Cables, Dampers and Ductwork.

FireDNA software catalogues Manufacturers product data, digitally shares it with Contractors and Installers, who in turn add their installation data, passing that onto Building Owners, Facilities Management Teams and Tenant Management Organisations.

That data can then be used by Building Control, Maintenance Teams, Fire Inspectors and viewed by Tenants and Residents alike, with a simple swipe of a mobile device.

FireDNA digitally links everyone in the chain of responsibility and creates a 'Golden Thread' of information across the full product lifecycle from cradle to grave.

To find out more about how FireDNA can assist you, or for more information about our products and services, please visit: www.fire-dna.com or call our team on: 01403 597590.

FireDNA™
Monitoring Passive Fire Products

PARK REALTY GROUP
WE MANUFACTURE
Luxury & Eco Lodges
Residential Park Homes
Caravans

QR Code
& Sales & Marketing Suites
Park Facility & Amenity Buildings

0800 090 3052
parkrealtygroup.co.uk

10 YEAR PLATINUM SEAL
AWARD - LEISURE LODGE MANUFACTURERS

Photography Video
Drone CGI
Virtual Tour Web Design

Sell more with our services!

CALL US
020 3290 5555
orb3d.co.uk
VISIT OUR WEBSITE

ORB

FELLOWS GRAB AWAY
07852560753

Grab Hire & Muck Away Services

We offer a grab hire and muck away services across the Midlands. All our vehicle comes with an experienced driver. We offer collection and delivery of green waste, soil and aggregates. Whether its a large commercial development or a smaller domestic project, our grab hire provides a cost effective way to manage your waste.

- Supply of Aggregates
- Muck Away
- Green Waste Removal
- Digger hire
- Screener hire

Please visit www.fellows-grabaway.co.uk
T 07852 560 753 | info@fellows-grabaway.co.uk

M&M KENT SERVICES LTD

We are distinguished Drylining specialists with over 20 years experience in the industry. Our team is committed to delivering excellence for all buildings in the UK.

We are specialists in internal finishes and facade, including:

- ✓ SFS and render installation
- ✓ Plastering or tape and jointing
- ✓ Partition walls
- ✓ Screeding
- ✓ Ceilings

GET IN TOUCH WITH US TODAY.
TEL: 01795 436 103
MOB: 07757 685 441
EMAIL: info@mmkentservicesltd.co.uk

smas WORKSAFE
SSIP SAFETY SCHEDULED TO PROCUREMENT

RP Associates.eu

RP Associates is a global outsourced company specialising in **Procurement, Credit Control & Marketing.**

RP Associates provide a first class service, from consultation to facilitation, ensuring all clients' needs are met, sourced and delivered.

For more information contact
roger@rpassociates.eu

Sussex: +44 (0)1825 791703 London: +44 (0)207 206 7349

Service Sealing Solutions Ltd visit DOYMA

Service Sealing Solutions Ltd is the sole UK distributor for the sealing industry's top manufacturers; DOYMA and HKD. Service Sealing Solutions Ltd supply the full range of DOYMA and HKD products, to suit all situations from sealing power cables, communications cables, pipes and ducts and district heating pipes, permanently preventing an infiltration of gases and water into the building. DOYMA's products are designed to solve all watertight sealing requirements and prevent against structural damage. DOYMA products are also guaranteed watertight for 25 years.

HKD which is now owned by DOYMA, manufactures a vast range of pipe sealing systems and service ducts with a guarantee that its products can withstand up to four bars of pressure. All of the HKD product range can be combined with the DOYMA's Curaflex range, one of the most popular DOYMA ranges.

Service Sealing Solutions Ltd specialises in high-quality service duct sealing systems for utility services and watertight seals,



Husband and wife team, Jim & Tina have recently visited DOYMA in Germany to find out about the innovative products that DOYMA have been developing

offering the highest level of expertise to developers and specifiers for sealing against water and gas entering around service entries in basements and high-rise buildings.

Contact
T 01952 510050
tina@servicesealingsolutions.co.uk
www.servicesealingsolutions.co.uk

Service Sealing Solutions Ltd – suppliers of DOYMA products

Service Sealing Solutions Ltd are the sole UK distributor of DOYMA products. Wherever services are installed through walls, ceilings or floors, penetrating water may cause damage to buildings. Lack of attention to the points of entry of pipes and cables into the building can have serious results: damp cellars, equipment damaged by water ingress and high repair costs. Service sealing systems ensure professional and perfect pipe sealing, thus presenting excellent preventative measures against structural damage. The very best in German engineering is used to seal penetration points at the wall to permanently prevent any infiltration of gases and water into the building, and the duct sealing systems are guaranteed for 25 years. Service Sealing Solutions supply the full range of products to suit all situations for power cables, communication cables, pipes and ducts, and specialising in sealing district heating pipes.

01952 510050 www.servicesealingsolutions.co.uk
sales@servicesealingsolutions.co.uk

Lanes Rail passes ISO 9001 and ISO 14001 audits with flying colours



Lanes Rail has passed its latest ISO quality and environmental audits with no non-conformities – the third year in the row it has achieved perfect audit outcomes.

The achievement confirms Lanes Rail, a division of Lanes Group plc, holds certification for both ISO 9001 for quality and ISO 14001 for environmental management.

Daniel Ward, Health, Safety, Quality and

Environment Manager for Lanes Rail said:

“Achieving certification for both standards with no non-conformities for three years is a great achievement.

“It reflects the standards set by all our colleagues and the willingness of Lanes Group to invest in equipment and working practices that allow us to continuously improve.

“The auditors from BSI do not just look at our management systems, they go out on site and see how they're put into practice. So everything must be in place and working as it should to not get any non-conformities.”

Sustainable operations

The achievements also means Lanes Rail clients, including Transport for London and Network Rail, can be confident the ISO 9001 and ISO 14001 are not just met but fully underpin work carried out, Dan Ward added.

ISO 9001 defines good and effective quality standards, supported by a quality management system, across a range of parameters, including customer focus, risk management, and leadership.

ISO 14001 considers all aspects of an organisation's work related to environment protection, waste management and sustainable operations, including efforts to reduce carbon emissions.

Lanes Rail is a leading provider of services to the rail industry. It manages major contracts for Transport for London, delivering drainage, structure maintenance and repair, vegetation control and lock management services.

Electric vans

It could point to significant investment in new vehicles which means all 66 vehicles in its fleet, with the exception of three vans, are Euro 6 compliant, the highest standard for reduced emissions and fuel efficiency.

The division has also invested in two electric vans which are used by plumbers to travel between London Underground stations to carry out repairs.

Lanes Rail also uses a highly-effective digital work management tool, called Teamleaf, which it has adapted to its own needs, to streamline workflows, improve customer service and make sustainable operational decisions.

www.lanesgroup.com

Drainage engineers use “exemplar” safety systems to clean deep railway sump

Rail for London (RfL) commissioned leading rail specialists: Lanes Rail: division of Lanes Group plc, to clean a sump along the 73-mile length of the Elizabeth Line.

The sump in Silvertown, East London, next to London City Airport was 25 metres deep and is the deepest wastewater asset along the length of the new line.

In-house safety experts: Lanes Rail Health, Safety, Quality and Environment Manager: Dan Ward and Project Manager: Aaron Turner designed a work to protect the four Drainage Engineers.

The Lanes Rail engineers had to descend a shaft equivalent to the height of an eight-storey building to clean the sump.

The clean-up mission required detailed planning, as Dan Ward outlines:

“This was one of the deepest shafts Lanes Rail operatives have ever worked in. Our safety systems had to reflect a range of serious hazards our team faced during the three day operation.

“All our drainage engineers had undergone confined space training and we very carefully assessed all eventualities in creating a bespoke risk assessment and method statement for this project.”

The Connaught Road Pump House: a seven-metre-diameter concrete ring shaft, has two sets of pumps that manage surface water from several locations along a portion of the Elizabeth Line.

The work was carried out when no rainfall was predicted, as the shaft was essentially designed to hold maximum surface water up to half its height during heavy rain periods.

The highly-skilled engineers needed to descend shaft ladders linked by seven landings, to reach the sump waste pit beneath the pumps.

Each engineer wore a harness and was clipped to fall arrest lines, strategically set up between each landing. They were issued gas monitors and confined space emergency escape sets, with small tanks holding 30 minutes of air.

The engineers were supported at all time by a three-person space rescue team, with breathing apparatus from Health & Safety specialist: ESS.

For the duration of the operation, one member of the rescue team was with the Drainage Engineers and two stayed on the surface.

The shift had an encompassed electric winch for planned preventative maintenance, helping remove sump material and in case of emergency personnel rescue.



Before the clean-up, all the ladders, guardrails and floor assets in the shaft had been inspected and recorded, landing-by-landing and deemed safe and fit-for-purpose.

The team removed silt and other debris from the two-metre-deep pit, with all sludge loaded into one-tonne bags and winched above ground for safe disposal. Aaron Turner explains further,

“In the event, we removed no more than two tonnes of silt. This will give RfL good guidance for planned maintenance needs going forward.”

www.lanesgroup.com

brightideas
consulting & development

Bright Ideas would like to announce its next development. We are planning to regenerate this pub in Sunderland - The Half Way House.

Working in partnership with Sunderland City Council and Changing Lives, we are planning to buy the pub and provide a supported accommodation scheme consisting of 7 bedrooms and additional staff accommodation. Our aim is to partner with the City to provide something which is both dynamic and much needed. By offering 24 hr support the Council working with Changing Lives will support vulnerable people and save money across the wider budgets.

Bright Ideas working in partnership, supporting people, making budgets go further

www.brightideasdevelopment.co.uk
Telephone 07714 412689
Email info@brightideasdevelopment.co.uk

CARTER SYNERGY

Carter Synergy are a national provider of Refrigeration, Air Conditioning, Mechanical, electrical and core building services.

We are rightly proud of our long history serving some of Britain's best-known businesses across a wide range of environment. We are a business built on engineering excellence.

Some of our services are:

- A range of service & Maintenance options tailored to your site.
- Refrigeration systems to suit any environment.
- Air Conditioning supply, install and maintenance.
- Coldstores, fixed and mobile rental units.
- Coldstores repairs, Delap surveys and consultancy.
- Refrigerated cabinets to suit any retail environment.
- Core Electrical, mechanical, and general building service support and solutions.
- Fixed refrigerant leak detection systems to meet with your compliance and legislative requirements.
- A range of controls and energy reduction products and tools.
- Net Zero and Decarbonisation consultancy.

Contact Details:
Miss Sam Parris: 07817 053 291
Enquiry@cartersynergy.com
www.cartersynergy.com

Specialist Applied-skills Programmes in Lead or Hard Metal

The Lead Sheet Training Academy (LSTA) has been delivering Specialist Applied-Skills Programmes (SAP's) for CITB since 2009. Since then, over 200 students have been registered for the programme. There is a very high level of achievement, with users rating the courses highly.

We are appointed by CITB as a provider of this course across England, Scotland, and Wales. Grant funding is available to meet most of, if not all the course fees. CITB have also introduced the "Travel to Train Scheme" which gives financial assistance for accommodation, food & travel, where 80% of the costs are covered through this scheme. To find out more:

www.citb.co.uk/levy-grants-and-funding/grants-and-funding/apprenticeship-travel-and-accommodation-funding-travel-to-train

SAPs are available at both Level 2 and Level 3 dependant on experience, in either Hard or Soft Metals (not combined).

The level 3 NVQ is fully funded. To find out more: leadsheet.co.uk/service/the-lsta-specialist-applied-skills-courses

The LSTA offers six certificated courses, each of these courses are CITB and City & Guilds Accredited Programmes. A deposit of 50% or £450.00 will reserve your place with the remaining balance due 10 days before the course starts. Please go to the following link: www.leadsheet.co.uk/service/lstas-lead-hard-metal-courses

Rolled Lead Sheet Manual is ready to order.
Available online as an e-Book and as a printed copy or
Call 01622 872432 or Email info@leadsheet.co.uk



ACCREDITED COURSES AVAILABLE:

- Traditional Basic Leadwork Craft – this course is also available as two 3-days courses
- Traditional Intermediate Leadwork Craft (35-day course – split into 4 modules each taking 5 to 10 days) *Modules can be purchased separately.*
- Traditional Advanced Leadwork Craft (15-day course)
- Traditional Basic Hard Metal Craft
- Traditional Intermediate Hard Metal Craft (30-day course – split into 4 modules each taking 5 to 9 days) *Modules can be purchased separately.*
- Traditional Advanced Hard Metal Craft (15-day course)
- Safe use of STIHL Petrol Driven and Battery Powered Cut Off Saw with Abrasive Wheel (1-day NOCN Certificated course)
- Specialist Applied Skills Programme (SAP) in Lead or Hard Metal (Level 2 and Level 3). Each of these courses will take up to 18 months to complete including 30-days attendance at the LSTA centre, split into one-week blocks.

For more information on all our courses and CITB grants please visit our website or you can call the main office on 01622 872432 or email info@leadsheet.co.uk and speak to Sharon or Emmi.

Follow us on <https://twitter.com/LSTATraining>
www.facebook.com/LeadSheetTrainingAcademy/
www.linkedin.com/company/lead-sheet-training-academy/
www.instagram.com/lsta_academy/

Unit 10 Archers Park,
Branbridges Road, East
Peckham, Tonbridge,
Kent TN12 5HP

01622 872432
info@leadsheet.co.uk

Access Panels and Riser Doors

At Rapid Access, we understand visually aesthetic designs, evaluates the quality of your work! As a leading manufacturer in the Access Panel world, we are always looking for new sleek ways to improve our products and your projects.

Our new invisible ironmongery is now available on our Riser Doors with a sleek new element. Our magnetic fire door keep locked shut sign simply slides away from the door face to reveal the hidden ironmongery.

These door sets can be easily opened to provide access to services in buildings such as water, electrical, mechanical, gas, telecommunication compartments, HVAC systems, and many other maintenance options. Rapid Access offers either a piano hinge system or our fast, quick and user friendly Rapidfit® hinge system, which has revolutionised the riser door. Say goodbye to old Piano Hinge technology and say hello to future of Access Panels.

As no cap is required to hide the lock, this new feature is completely maintenance free, this means we have eliminated additional moving parts when accessing the lock.

Our new design is available up to 2 hour fire rated and up to 36dB acoustic rated. Rapid Access can also offer this new feature in both single or double door units ranging from 2,400mm x 1,800mm.

The company specialises in manufacturing steel products, and it currently has two unique products that offer ease and money saving aspects when fitting the panels that Rapid Access Ltd have designed. These are the



Rapidfit® hinge system for Riser Doors and the unbeatable Flipfix panel for wall and ceiling use.

The FlipFix range launched in 2015, offers a unique fitting device, Mitreless frame and new Flush Lock system. The innovative box packaging for stock sizes doubles as a pop-out template – simply draw around the template and cut your hole ready. The FlipFix device easily secures the access panel against plasterboard or drywall with a thickness ranging from 8mm to 32mm, and this allows the panel to fit flush to the wall providing a clean overall finish. FlipFix complies with the performance criteria for integrity using the principles of BS EN 1634-1: 2014.

Rapid Access Ltd are also the inventors of the trademarked RapidFit® hinge system on its riser door range, and this hinge system

has revolutionised the riser door by reducing door fitting times on site by as much as 95%. Working on a spring-loaded pin hinge means that installation of the door, once the frame has been installed is much quicker than a door supplied with a traditional piano hinge.

In a crowded marketplace, Rapid Access Ltd works hard to stay at the forefront of the industry, and it has a committed and exclusive team that works on product development. Using previous and market leading research the team constantly works on new products that its loyal customers can promote with pride. The company is also always looking to pioneer its established name into all industries by way of bigger and better ideas.

Contact
T 024 7632 8811
sales@rapidaccessltd.com
www.rapidaccessltd.com

Qualitative and quantitative fit testing and fit test training

We have experience in face fit testing, and we have Fit2Fit accredited fit testers in our team. Meaning our methods have been checked and confirmed with best practice for face fit testing in line with the BSIF and HSE.

Our experienced dental team, with a wealth of dental experience are now delighted to be able to offer a fit test service for FFP3, FFP2 and FFP1 masks. Using the 3M qualitative testing kit, we can arrange appointments at your workplace to fit test your staff, with your own masks.

Quantitative face fit testing eliminates the guesswork associated with error-prone qualitative fit test methods. Using the PortaCount Pro Respirator Fit Tester 8030 fit tester, we can now quantitatively fit test so

many types of respirators – gas masks, SCBAs, respirators. If the mask requires fit testing, count on the PortaCount Pro fit tester to provide the fastest and easiest HSE (UK) and OSHA (US)-compliant fit test method.

We also provide fit test training at our Head Office in Winnersh, Wokingham – The Train the Tester course to provide you with knowledge, skills and confidence or Train the Tester RPE Refresher, which is hands on and practical.

Contact Andy at: andy@cavity-fit-test.co.uk or call: 0118 214 6192 to get your local fit tester today.

You can visit: www.cavity-fit-test.co.uk for more information.



Stanza Blue

Zoo Hardware is a designer and supplier of architectural door hardware, including door handles, knobs, locks, hinges and much more. Dedicated to ensuring its products meet the highest standards, Zoo Hardware uses only high-quality aluminium, brass, steel and zinc. This eye for detail and dedication to quality is of the utmost importance for Zoo Hardware and as such, the company is confident that it can provide the highest quality products at the most competitive prices.



ZPA090 – Bilbao Lever

Boasting unrivalled design skills through the company's in-house design team, Zoo Hardware assures its customers that they will receive top-end products, developed by its team of designers, who are highly qualified and experienced in all aspects of design and production. The team constantly aims to push the boundaries of possibility for its designs, creating innovative, stylish and cost-effective hardware solutions.

The Stanza Blue ZPA range is a new and exclusive collection of designer aluminium levers built on a zinc screw on rose or aluminium backplate and is ideal for housebuilders and homeowners alike. The full metal construction of these levers utilises quality materials at a great price without compromise, whereas inferior alternatives on the market use aluminium for both the lever and rose, which can easily suffer from cross threading of the outer rose.

Offering a broad selection of lever styles to suit even the most discerning tastes, the range consists of a mix of seven classic lever on rose designs with the addition of three new contemporary in-house designed levers, and two lever on backplate options for the more traditional residential feel.

All variations are available in three distinct finishes: Polished Chrome, Satin Chrome, and Matt Black, each one suitable for any modern or traditional interior. The inclusion of a high-quality Matt Black finish at this ranges' price point will be an exciting addition for customers, and with black levers having cemented themselves as a fashionable interior design trend, we are certain they will be a popular choice for many households throughout the UK.

www.zoohardware.co.uk

Plastering and flooring specialist restores buildings to former glory

MKM Contracts has been a leading plastering and flooring specialist for over 30 years across the UK and Ireland. Under the steely helm of expert Director, Pdraig McAtamney, this renowned business has worked on all building areas from five-star hotels, listed heritage buildings, private residential and social housing, healthcare, even Buckingham Palace in 2021.



Pdraig McAtamney is well respected in the industry, with a niche background in lime and lath rendering in heritage building restoration and oversees all aspects of project management, from initial consultation, on-site work, to completion. As an approved contractor for K-rend and Sto and specialist lime and lathe rendering systems, MKM has carried out delicate rendering on The National Trust Cottages in Kent and listed heritage buildings in Highgate, London.

Heritage-industry approved lime rendering can be carried out on both modern, and historical buildings, with the advantage that it is more pliable than OPC based products, allowing older buildings in particular space to insulate, reducing building joint movement.

Beyond lath and lime rendering, MKM can

offer quality assured work on: krend, EWI Insulated systems, all coloured renders, acrylic renders, traditional renders, floor screeds, dry lining, metal partitions and plaster boarding.

Speak to Ailish McAtamney: MKM Marketing Manager today for more information:

T 07966 551965/07427 154670
mkmplasteringtd@gmail.com
www.mkmcontracts.co.uk

Looking lean – Strand makes warehouse improvements

Strand Hardware has developed leaner assembly, dispatch and warehousing processes – saving hundreds of staff hours each year – in a joint project with a crack team from Warwick University.

The project with WMG (Warwick Manufacturing Group) has optimised warehouse layout and movement for the efficient flow of picking, assembly and packing operations across key ranges. It involved measuring processes via time study and motion analysis through site visits, video capture and process flow assessment. Findings outlined cycle times and mapped the movement of people.

The resulting report outlined a series of recommendations to improve process capacity, including quick wins and minor modifications to warehouse and workstations layout to introduce time savings. This has led to the introduction of mobile Kanban shelving within the assembly area to allow components to be picked and assembled more efficiently. The double-sided racks allow bins to be restocked by a dedicated person who conveys stock between Strand's warehouse and its head office on another part of the site.

Steve Marshall, Managing Director of Strand

Hardware, said that the project had been 'thorough and exacting.'

"Strand Hardware has grown over 30 years. Like most companies, while scaling up, we have focused on customer requirements and day-to-day business operations. We felt that the time had come to review what we were doing and whether we could be doing it more efficiently, which led to the opportunity to work with WMG.

"Having experts come into the business with fresh pairs of eyes, ask the right questions and with the knowledge to assess and analyse our operations has been invaluable. It was important for us not to disrupt warehouse activity, so recommendations had to incorporate improvements that would be easy to apply. In the long term, this will make our business leaner and more efficient – the ideal foundation for future growth," he said.

The project was undertaken with funding from the Digital Innovation for Manufacturing programme.

Strand Warehouse and Production Manager Andy Michel said that it had been fascinating to work with the University Team, "The results will make the job easier for many of the team and help Strand Hardware in its continuous improvement."



Chris Wang, of WMG SME Group added, "WMG and Strand Hardware have worked collaboratively to analyse their current assembly area in readiness for optimising their production facility. Across the three recommendations put forward, a maximum 50% reduction in cycle times per unit has been predicted which allows for a 5.105% capacity increase."

For more information on Strand Hardware's range of products, contact: info@strandhardware.co.uk, call: 01922 639111 or visit: www.strandhardware.co.uk

KELLY TANKS

DEALING WITH WASTE WATER ONSITE?

KELLY TANKS PROVIDES

CONCRETE WASHOUT & WATER TREATMENT SYSTEMS

SO THAT YOU CAN EASILY RE-USE OR SAFELY DISCHARGE YOUR ONSITE WASTE WATER





LEADERS IN OUR FIELD

Consulting on various aspects of project design, constructability and operational lifecycle matters for local and global commercial clients.



DCON Safety Consultants awarded Excellence in Business Award - Safety Specialists by The Public Sector Magazine 2023 as well as Excellence in Health & Safety in the Fit Out Awards 2022.



DCON Safety Consultants
Suite 5, Fitzwilliam Square East, Dublin 2
Email info@dconsafety.com
Phone +353 (0)1 611 1556
www.dconsafety.com